



NOT LEGAL FOR SALE OR USE ON ANY POLLUTION CONTROLLED MOTOR VEHICLE IN CALIFORNIA OR STATES ADOPTING CALIFORNIA EMISSION PROCEDURES.  
See knfilters.com for CARB status on each part for a specific vehicle

# INSTALLATION INSTRUCTIONS

## 77-3111KC CHEVROLET / GMC 2019-20 Blazer / Acadia 2.5L

### TOOLS NEEDED:

- Flat blade screw driver
- 3mm allen key
- 4mm allen key
- T20 TORX key

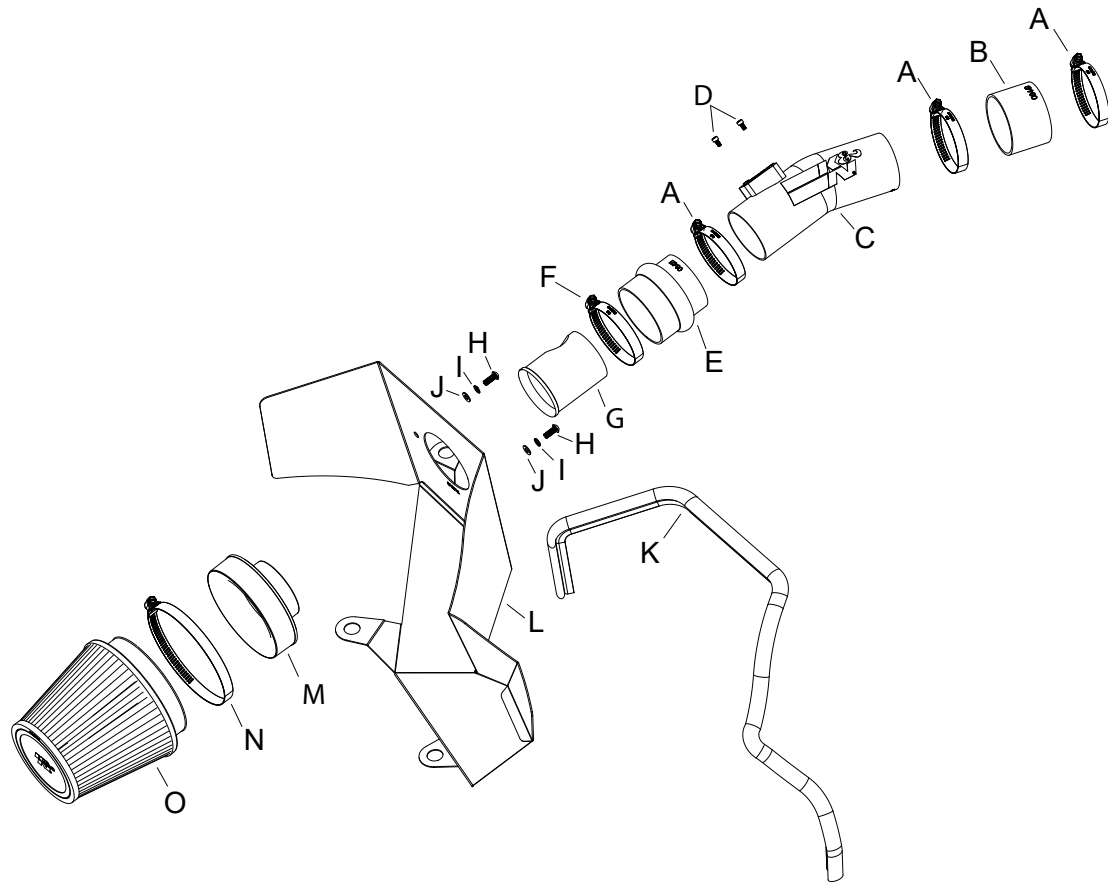

### PARTS LIST:

Description	Qty.	Part #	Description	Qty.	Part #	Description	Qty.	Part #
A HOSE CLAMP; #48	3	08577	F HOSE CLAMP; #48	1	08601	K EDGE TRIM; 3/4" BULB	1	102499
B HOSE; 2.75"ID X 2"L	1	08440	G VENTURI; 2.59"OD X 2.37"ID	1	9-0381	L HEAT SHIELD, MILD STL	1	073312
C TUBE; 2.75"OD X 8"L	1	25842C	H BOLT; M6 X 1 X 16MM	2	07730	M ADAPTER; FILTER	1	21569
D BOLT; M4-.7 X 8MM	2	07733	I WASHER; M6 SPLIT LOCK ZINC	2	1-3025	N HOSE CLAMP; #88	1	KITHS88
E HOSE; HUMP 3" TO 2.75" X 3"L	1	08421	J WASHER; 6MM FLAT	2	08269	O 5" FLG, 6-1/2"B	1	RU-2800

If you need any assistance please call 1-800-858-3333 to speak with a representative in our Customer Service Center before returning the product.

**NOTE: FAILURE TO FOLLOW INSTALLATION INSTRUCTIONS AND NOT USING THE PROVIDED HARDWARE MAY DAMAGE THE INTAKE TUBE, THROTTLE BODY AND ENGINE.**

### TO START:

1. Turn off the ignition and disconnect the negative battery cable.  
**NOTE: Disconnecting the negative battery cable erases pre-programmed electronic memories. Write down all memory settings before disconnecting the negative battery cable. Some radios will require an anti-theft code to be entered after the battery is reconnected. The anti-theft code is typically supplied with your owner's manual. In the event your vehicles anti-theft code cannot be recovered, contact an authorized dealership to obtain your vehicles anti-theft code.**



2. Disconnect the mass air sensor electrical connection and loosen the hose clamp that secures the intake hose to the plenum. Pull straight up and remove the complete air filter housing assembly from the vehicle. **NOTE: K&N Engineering, Inc., recommends that customers do not discard factory air intake**



3. Install the radius filter adapter into the heat shield and secure with the provided hardware.



4. Install the edge trim onto the heat shield as shown. **NOTE: Some trimming of the edge trim may necessary.**



5. Remove the three factory mounting grommets from the factory air filter housing and install them into the K&N heat shield as shown.



6. Install the heat shield assembly onto the mounting studs as shown.



7. Install the provided hump coupler onto the filter adapter and secure with the provided hose clamp.



8. Install the provided straight coupler onto the intake plenum and secure with the provided hose clamp.



9. Remove the mass air sensor from the factory housing and install it into the K&N intake tube using the provided hardware.



10. Install the maf sleeve into the K&N intake tube so the lip on the end of the sleeve stops against the end of the intake tube.



11. Install the intake tube into the hump coupler and then into the straight coupler, adjust the tube for best fit and then secure with the provided hose clamp.



12. Reconnect the mass air sensor electrical connection.



13. Install the K&N air filter onto the intake tube and secure with the provided hose clamp.



14. Reconnect the vehicle's negative battery cable. Double check to make sure everything is tight and properly positioned before starting the vehicle.

15. It will be necessary for all K&N® high flow intake systems to be checked periodically for realignment, clearance and tightening of all connections. Failure to follow the above instructions or proper maintenance may void warranty.

#### ROAD TESTING:

1. Start the engine with the transmission in neutral or park, and the parking brake engaged. Listen for air leaks or odd noises. For air leaks secure hoses and connections. For odd noises, find cause and repair before proceeding. This kit will function identically to the factory system except for being louder and much more responsive.

2. Test drive the vehicle. Listen for odd noises or rattles and fix as necessary.

3. If road test is fine, you can now enjoy the added power and performance from your kit.

4. K&N Engineering, Inc., requires cleaning the intake system's air filter element every 100,000 miles. When used in dusty or off-road environments, our filters will require cleaning more often. We recommend that you visually inspect your filter once every 25,000 miles to determine if the screen is still visible. When the screen is no longer visible some place on the filter element, it is time to clean it. To clean and re-oil, purchase our filter Recharger® service kit, part number 99-5050 or 99-5000 and follow the easy instructions.

**NOT LEGAL FOR SALE OR USE ON ANY POLLUTION CONTROLLED MOTOR VEHICLE IN CALIFORNIA OR STATES ADOPTING CALIFORNIA EMISSION PROCEDURES.**

See [knfilters.com](http://knfilters.com) for CARB status on each part for a specific vehicle

\* FREE K&N® decal To register your warranty, please see us online at [knfilters.com/register](http://knfilters.com/register). FREE K&N® decal \*